



USER MANUAL

**PORTABLE AND SWIM SPAS
OPERATING MANUAL**



Congratulations...

Congratulations on becoming a Spa owner! You'll find the control systems in our spas have been designed for simplicity and can be programmed to suit your individual preferences. With the proper care and service of your new spa, and the correct chemical maintenance of the water, your spa will provide years of enjoyment. Please take time to read this manual carefully before operating your spa.

Important: Do not power up your spa until you have read this entire Operating Manual. Improper installation may result in equipment damage and void the spa warranty.

CONTENTS

Spa Hardware Orientation	1	Jets Information	16
Touchpad Control Centre		Spa Maintenance	17
Control Box		Cleaning The Spa Shell	
Main and Boost Pump		Maintaining The Spa Hardcover	
Circulation Pump		Cleaning The Filters	
Spa Hardware	2	Jet Maintenance	
Ozone		Diverter Valve Maintenance	
Heater		Headrests	
Blower		Spa Cabinet	
Aromatherapy Canister		Chemicals For Your Spa	
Premium LED Lighting		Sanitising Your Spa	
Bluetooth Sound System		Changing The Water	
Massage Jet		When Your Spa is Not in Use	
Diverter		Winter Preparation	
Waterfall Valve		Drain Your Spa	23
Air Regulating Valve		Water Quality & Maintenance	24
Drain		Water Test Method	
General Information	4	Basic Chemical Safety	
Spa Serial Number		How To Add Chemicals To The Water	
Identification Compliance Label		Water Quality Maintenance Program	26
Safety Instruction	5	Total Alkalinity(TA) Adjustment	
Installation	8	Calcium Hardness(CH) Adjustment	
Preparing A Foundation For Your Spa		pH Value Adjustment	
Installation In Outdoor And Courtyard		Keep The Concentration Of Disinfectant	
Preparing For Spa Leveling		Water Treatment System	
Cover Installation		Replacement Instructions For Cartridge Filter	
Electrical Connections	11	Chloride(Sodium Bichloride)	
Requirements		Superchlorine	
Cable Duct Installation Instructions		Make Daily Disinfection Plan	
Power Consumption		Water Quality Maintenance Supplementary Program	31
Filling Your Spa & Starting Up	13	Mineral Deposition Inhibitor	
Operation Instructions	14	Ozone System	
Control System Instructions		Clean Of The Ozone Jet	
Bluetooth Sound System Instructions		Trouble Shooting & Service	37
Valves Information	15		

SPA HARDWARE ORIENTATION

Touchpad Control Centre

Located on the topside of your spa. This touch pad operates pumps, blower, temperature adjustment and other ancillary functions that you may have, such as filter cycles, lights and diagnostic codes.



Control Box

Where power supply, blower, ozone and circulation pump are connected. Located in the engine bay of your spa. (Under the touch pad control)



Main and Boost Pump

Located in the engine bay of your spa, this is the largest of the pumps in size and power. Used for creating water pressure through jets. Also used for filtration in the case of a 2-speed pumps option (refer to Controller Instructions).



Circulation Pump

(if fitted) Located in the engine bay of your spa. This highly efficient, small power usage pump is used in the filtration and circulation of water through the heater.



SPA HARDWARE

Ozone

(if fitted) Used for water purification. For additional chemical requirements when using ozone, contact your Authorised Spa Dealer for advice.



Heater

Housed with the control box.



Blower

(if fitted) Located in the engine bay of the spa. Its purpose is to blow air through the air injector to create bubbles.



Aromatherapy Canister

(if fitted) Located on the topside of the spa. This canister holds the Aroma Beads. To access the canister, unscrew the cap in a counter-clockwise direction. Ensure blower is not operational when removing cap.



Premium LED Lighting

(if fitted) Multiple colours of LED can be set via control panel, to create a warmly and romantic relaxation surrounding.



Bluetooth Sound System

(if fitted) Premium Bluetooth sound system allows you to pair your smartphone, laptop or tablet with our dual waterproof speaker, simply turn on bluetooth on your device and search for **"Joyonway" Bluetooth password 2288**.



Massage Jet

All massage jets are equipped with stainless steel cover. It connected with massage pump, water come through jets to bring you high pressure massage, and it has different massage core, which it can provides different massage mode through different types of massage jets.



Diverter

(if fitted) Allows you to guide the water from the jet pump to different jet combinations.



Waterfall Valve

(if fitted) Its function can form injected water to different shapes, to adjust the water flow in low high speed.



Air Regulating Valve

(if fitted) Allows you to enjoy massage with different pressures from the jets.



Drain

The water in spa can be flowed out through this drain.



Spa Serial Number

Your spa has its own serial number. This number will need to be quoted if warranty service is required. This number can be found on the bottom of the spa base.

- Name Plate - Located on the bottom of the spa base under the Touchpad side (Image A).

Identification / Compliance Label (Portable Spas and Swim Spas)

All Spas come complete with their own Identification / Compliance Label which can be found on the bottom of the spa. It is an aluminium plate containing a host of information (pictured below in Image A.)

Information will need to be given to the Authorised Spa Dealer when purchasing consumables (eg. filters or chemicals) or in the event of organising routine servicing of the spa or warranty requirements.

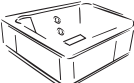
*Luxury Massage Hothtub*

Model:	<input type="text"/>	Voltage:	<input type="text"/> V
Code No.:	<input type="text"/>	Hertz:	<input type="text"/> Hz
Serial No.:	<input type="text"/>	Max Load:	<input type="text"/> A
Shell Color:	<input type="text"/>	Heater:	<input type="text"/> kW
Controller:	<input type="text"/>	Dry Weight:	<input type="text"/> kg









Image A

SAFETY INSTRUCTION

Please read the following guidelines and carry out the operation according to all of the instructions to avoid safety accidents. We strongly recommend you to read the following guidelines and follow all instructions.

Dangers:

- Prevent children from privately entering into the spa. Ensure that children enter into the spa and use the massage function under the close monitoring of the adults in the full duration, in order to avoid any accident.
- When replacing the water pumps and related components, the new parts should be consistent with the original specifications, in order to prevent from the damage to the human body caused by the change of flow rate.
- In order to avoid the risk of electric shock, please do not put any metal piece within the range of 1.5 meters around the massage pool, unless the metal piece surface is permanently grounded with a single wire with a section area over 10 mm (28AWG), and the solid core copper grounding wire is connected to a cable connector of the grounded box, otherwise, the spa can be installed in a area 1.5 meters away from the metal surface.
- Placement of any electronic device such as electric light, telephone, radio or television within 1.5m from the spa is forbidden. If the safe distance between the above mentioned electronic devices and the spa is not kept and the electronic device falls into the spa, this may lead to death or serious injury.

Warning:

- In order to reduce the risk of electric shock, broken wires should be replaced immediately. Otherwise, the electric shock may lead to death or serious injury.
- Before each use of the spa, please check the ground fault circuit breaker. If the ground fault circuit breaker can not operate normally, the leakage of ground current may cause electric shock to people. In this case, please disconnect the power supply, until the fault is determined and repaired.
- Before entering into the spa, the water temperature should be measured. The water temperature in the spa may not exceed 40°C(104°F), For healthy adults, the temperature of 38°C-40°C (100°F-104°F) is safe. For babies, a slightly lower water temperature is more appropriate, when using the spa for more than 10 minutes. For pregnant women or women who may become pregnant, the temperature should be controlled under 38°C (100°F). The human body is exhausted and the force is not left.

- Long time soaking in hot water can result in high body temperature, the symptoms of which include non-predictability of danger, for example: water burns can be caused without sensing the heating, the human body is exhausted and unable to leave the massage pool as well as unconsciousness that can result in drowning.
- Drinking alcoholic beverages or taking medicines before or during using the spa may lead to unconsciousness and cause accidents.
- Before using the spa, the patients taking medicines for long time due to heart disease, circulatory system disorders or pregnant women as well as the people taking medicines must firstly take the consultation from a doctor.
- The people taking the medicines with sleepy ingredients, especially the tranquilizers, antihistamines and anticoagulants are not allowed to use the spa.
- Before using the spa, the obese patients and the patients with high or low blood pressure, blood circulatory system diseases and the diabetic patients, or the patients having the history of heart disease must firstly take the consultation from a doctor.
- Risk of slipping and falling exists. Please remember and remind the people around you, that the wet surface is slippery and entering into the spa and stepping out of the spa must be very carefully.
- Please don't use the spa alone.
- Please take shower before and after using the spa. In order to reduce the possible spread of the disease, please keep the water within a certain range according to the parameters of "Water Quality And Maintenance". If you have listed similar situations, please stop using the spa and take medicines immediately.
- When using the spa, please don't remove the basket and the cartridge filter in filter box.
- Prohibit the use of calibrated flow rate was lower than the suction device to replace the original suction device, if the suction device is damaged or missing, do not use a spa bath. It is forbidden to replace the original suction device with the suction device with a flow rate lower than the rated flow rate. If the water suction device is damaged or missing, please don't use the spa.
- Loose clothing and hanging jewelry must be away from the selected jet, backwater device, filtration device or other moving parts.

Necessary:

- Before using, please ensure that the spa was installed by qualified professionals and the installation complies with the local electrical safety regulations and the requirements on the water and electrical installation.
- The electrical circuit in according to the electrical safety regulations and ensure to connect the power correctly - select a qualified electrical contractor!
- Please ensure that the spa is installed in a place with good ventilation and drainage. The drainage device must be away from electrical cabinet and all electrical components.
- Please take care for the safety of children and lock the children safety cover after each use, in order to prevent that the children open it and accidents occur.
- Please check the leakage protection breaker each time before and after using the spa and wait at least 30 seconds .

- Before restarting it. Ensure that the temperature of hot water supplied to the spa is less than 40°C (104°F).
- Please don't turn on the external circuit when draining water and electrical repairing. Please check the ground fault circuit breaker before each use.
- Before entering the spa tub, the user should measure the water temperature with an accurate thermometer, because the deviation of the temperature adjusting device will reach $\pm 2^{\circ}\text{C}$ ($\pm 5^{\circ}\text{F}$).
- Before allowing children to enter into the spa, please test the water temperature firstly with hand, in order to ensure a suitable water temperature, because children are very sensitive to hot water.
- When the spa is in trouble, it must not be disassembled and repaired privately or by non-professionals. In this case, please notice the dealer or contact the products service center immediately.

Precautions:

- Follow the precautions and maintenance methods of the spa recommended by this manual.
- Use of accessories according the specifications and recommended spa-chemicals and cleaning agents (for details, see "Water Quality and Maintenance").
- When not using the spa, regardless of whether there is water in the spa, the cover should be put on and locked.
- In the case that there is no water in the spa or the cover is not closed, the spa is not allowed to be exposed to sunlight, because this may damage the housing material and speed up aging of the accessories.
- Don't roll or slide on the side of a spa. It can damage the sidewall.
- In the case that the cover is locked, please don't open or pull the cover directly. You should use the handle to lift or carry the cover, in order to avoid damaging the spa-surface.
- Please don't try to open the electrical control box and to repair the parts in the box privately, Otherwise, the after sale warranty will become invalid. If there are problems by the operation, please carefully follow the operation procedure described in "Troubleshooting" of the electrical control box, that is attached to the spa. If you still can not resolve the problem, you can contact the authorized dealer of our company and the authorized service personnel can help you to solve problems easily through telephone.

INSTALLATION

Preparing A Foundation For Your Spa

You have perhaps selected a place for the new spa, either indoors or outdoors, in courtyard or on platform, the following points should be checked.

- The spa should be installed on a solid, flat, horizontal programme with good water drainage and air ventilation. The surroundings must keep dry in order to ensure the safety of the electrical components.
- Place can withstand this weight. The installation site can not be selected on the soft surface, such as sand, lawn and soft soil, etc.
- Before filling water, please remember to carry out leveling for your spa (see "Preparation For Spa Leveling").
- Please ensure that the spa cabinet contained all electrical components is away from the drainage system. If water enters into the spa cabinet, it will cause damage to electrical components or turn-off of the circuit breaker on the power distribution board.
- Please install the electrical components side(such as: controller, pump...) in a convenient location, in order to carry out the regular maintenance to the spa.

▲ Warning: Damages of the components or pipelines in the spa cabinet caused by mouse will not be covered under the warranty.

Installation In Outdoor And Courtyard

- Wherever the new spa is installed, a solid foundation to support the weight of the spa is important. Incorrect installation and structural damage caused by improper installation is not included in the spa warranty.
- If you install the spa outdoors, we recommend a reinforced concrete foundation with a thickness of at least 10 cm. According to the national electrical requirements, the reinforcing bar or steel net in the concrete foundation should be grounded.

Platform/Indoor/Basement Installation

- If you install the spa on a platform, please consult a qualified building contractor or structural engineer to know the maximum load bearing capacity of the platform, in order to ensure that the platform can withstand the weight of the spa.
- If you install the spa indoor, you have to understand certain special requirements. There will be water around of the spa, so the flooring materials must have good slip resistance. Water could sputter from the massage pool onto the floor around the massage pool. A correct drainage is necessary to prevent the water around the spa.
- If the spa is installed in the basement, the air humidity will naturally increase during usage and the moisture will enter the spa cabinet, and cause safety risks. In order to minimize these influences, sufficient ventilation for the basement is necessary. An architect can help you determine whether you need to install an additional ventilation device. But a correct drainage is also necessary.

▲ Warning:

- When the spa is installed indoors or in small spaces, please keep good ventilation surrounding the spa.
- Poor ventilation can lead to the accumulation of chemical substances or bacteria in the spa higher than normal levels. These anti-scatter chemicals or bacteria could be inhaled and cause breathing difficulties and lung damage of the patients with immune system or respiratory infection diseases. If you and others have these diseases, please see your doctor as soon as possible.
- We recommend installing the spa on the ground. But if the ground is on the same level to the upper edge of the spa, or higher than the spa upper edge because of laying floors, the risk of accidentally falling into the spa will be greatly increased. Therefore, please contact a qualified builder to design or evaluate your installation platform.

Preparation For Spa Leveling

The inclination of the concrete ground is preferably 1.3cm/3m, so rainwater and overflowed water spilled will flow out, and not remain under the spa (water remaining long time under the spa could lead to putridity of wood floor).

When selecting stepping stones or railway sleepers as the foundation for the spa, these should be placed below the entire spa and leveled, in order to keep the weight of the spa evenly distributed.

Please note, the soft ground will have a tendency to sedimentation, so that the spa is no longer in the leveling state, even if the weight of the spa has been evenly distributed as much as possible by using the stepping stones.

▲ Warning: If the spa is installed on the grass or muddy ground, the number of floating debris in water will increase and damage the equipment the surface of the spa. This situation is not covered by the warranty.

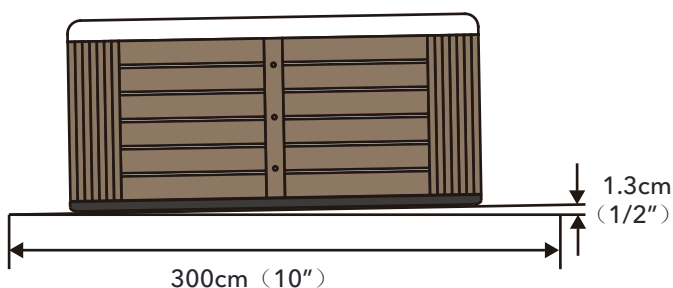

For correct water drainage, the inclination should be 1.3 cm (1/2 inch) / 305 cm (10 inches)

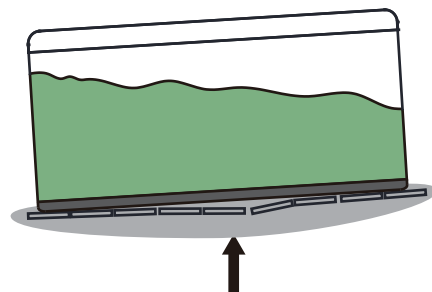

The spa could lose its leveling state because of the sinking of the stones or bricks

▲ **Tips:** Spa is specially engineered and can be installed on different kinds of common courtyard ground. The most suitable foundation is the concrete plates. But other foundations can also be used. You have only to prepare a foundation in the leveling state before delivery. When a spa is installed in a place without gazebo or other attachments, the concrete plate can be replaced by foundation examples shown in two foundation drawings on right side.

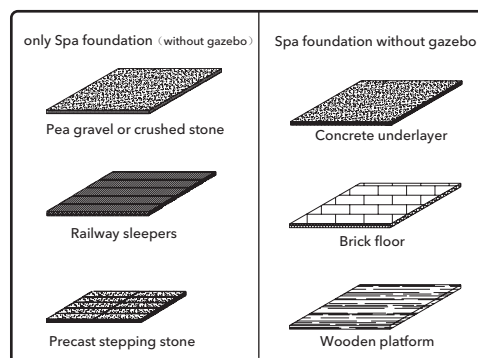

Cover Installation

- Spa is specially engineered and can be installed.
- Install the cover correctly on the spa.
- Fix lock catch of the cover on the spa cabinet, so that the cover band can be easily fastened on that. The cover band may loose 1.5-2cm, so that it can be easily inserted into the lock catch.
- Fix the lock catch with the provided screws and insert the cover band into the lock catch.

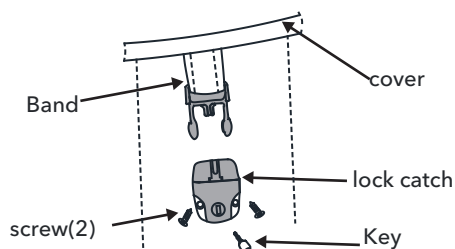

Danger: injury

- Do not let the Spa in uncover or unattended state
- Do not forget to lock the Spa cover
- Do not stand, sit or lie on the cover

ELECTRICAL CONNECTIONS

A qualified Registered Electrical Contractor must undertake all electrical connections. You must also have a Certificate of Electrical Safety issued by the Electrical Contractor at completion of the installation.

We provide maximum security for you to prevent electric shock. But, if the electrical circuit of the spa is connected incorrectly, many security functions of the spa shall be influenced. Please read carefully and follow completely the electrical installation requirements and instructions for the specific spa type.

Requirements:

1. Extension cords are not to be used under any circumstances.
2. Ensure the power supply is correctly rated.
3. Ensure all electrical connections meet the appropriate codes and standards.
4. Keep electrical connections dry at all times.
5. A licensed electrician ONLY, must connect the power.
6. Ensure spa is connected on a dedicated circuit protected by a safety switch.
7. Ensure spa is permanently and reliably connected to the fixed wiring.
8. Spa should be supplied through a Residual Current Device (RCD) with a rated tripping current not exceeding 30mA.
9. Parts containing live parts, except parts supplied with safety extra-low voltage not exceeding 12V, must be inaccessible to a person in the spa.
10. Never rest spa on power cords.
11. CAUTION: In order to avoid a hazard due to inadvertent resetting of the thermal cut-out, the spa must not be supplied through an external switching device, such as a timer or connected to a circuit that is regularly switched on and off by the utility.

Note to the Electrician:

You can find a reserved electrical hole through base for cable and conduit entry. Ensure cables are fitted through base prior to filling with water.

Cable Duct Installation Instructions

1. Find "Control Box Under this Cabinet" Sticker to locate the control box, If you cannot find the sticker, please find the Control Panel. The control box is usually on the same side.
2. When connecting the circuit, first remove the 3 screws from the bottom of spa cabinet and carefully pull down the spa cabinet, and then removed it from the spa completely.
3. Insert the cable pipe into the reserved electrical hole on the spa base and connect the cable with the control box according to the detailed description on the wiring diagram in the control box.

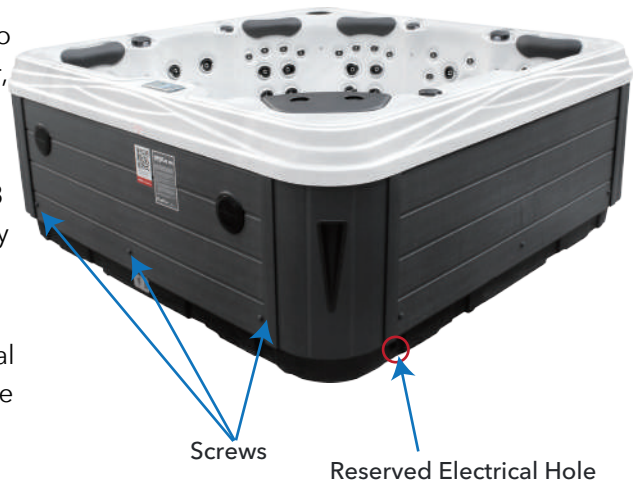

Power Consumption

The power consumption of your spa can be found on the Identification / Compliance Label of your spa (read about in 'Identification / Compliance Label' section of this manual). Power consumption is expressed in 'Full Load' and also 'Load Shed'.

Full Load - is the maximum full load current draw of the spa.

Load Shed - is a feature of the Control System which by a minor setting change will cause the heater to shut down when the boost pump or blower is actuated. Hence the lower power consumption valve.

Directions on ascertaining this setting can be found on the back of the Control Box lid.

FILLING YOUR SPA & STARTING UP

Filling Your Spa

- Before filling your spa, please open the filtration box, unpack and install the cartridge filter first.
- Before filling your spa, please tighten the barrels union. The barrels union are two big plumbing nuts located at the wet end of each pump and heater element. These can sometimes come loose during transportation.
- Check that the shut off valves are all in the open position (pulled up).
- Check that all jets are in the open position (Rotate clockwise to turn your jets on).
- When re-filling your spa, do so through the filter or diverter valve. (Tip!! When draining and re-filling your spa the filters should be cleaned, along with the spa surface, jets and behind the headrests. The latter three can be cleaned with methylated spirits.)
- Filter Box Diverter Valve - Fill your spa with water. This should always be done through the filter or diverter valves to stop air locks forming. Heat to desired temperature then test water balance and adjust pH, total alkalinity and chlorine.
(Ref: Water Quality & Maintenance section)

▲ Warning:

1. Do not fill hot water into your spa to avoid tripping of the overheating protection switch.
2. Do not fill "soft water" into your spa. (for details, see "Calcium Hardness(CH) Adjustment")
3. Do not switch on the spa without water in it. Otherwise, the Internal key components (such as controller, heater ...) will start automatically. It could be damaged and void your warranty.
4. Do not use the spa before completing all of the following steps, even if the spa has been filled with water.
5. Do not add chlorine when the spa is disinfected by using polyhexamethylene biguanide (biguanide, PHMB) disinfectants.
6. Close all drain pipes, fill water into the spa through the filter box by using a hose connected to the water pipe with a filter. Keep the water level one inch above the highest jet.

Starting Up

- If spa is a plug-in model, plug the power cord into the power point and switch the power on. If the spa is hard wired, turn power on at the main isolator. When the unit is powered up, it is normal operation that the spa pumps may turn on and run for up to 4 minutes depending on the type of controller.
- Chemical addition. Contact supplier in relation to the best chemical selection for your spa.
- To heat your spa adjust the temperature button up, or to decrease heat simply adjust the temperature button down (Refer to your control system instructions).
- Check for leaks, replace service access panels.

Note: Depending on water capacity, heater size and ambient temperature, it can take up to 12 hours to heat the spa to approximately 38°C. Swim Spas will take possibly twice as long.

OPERATION INSTRUCTIONS

Control System Instruction

Due to the different configuration parameters of the spa you have purchased, the control panel and control system of your spa also has certain difference, please find the details of control system instruction form your Authorised Spa Dealer.



YE.5 Controller+IN.K500/1000 Panel



YJ.2/3 Controller+IN.K500 Panel



GS100 Controller+VL260 Panel



GS510 Controller+VL801D Panel



P15B53 Controller+PB557 Panel

This above are several typical kind of our control system.

Bluetooth Sound System Instruction

(if fitted) Premium Bluetooth sound system allows you to pair your smartphone, laptop or tablet with our dual waterproof speaker, simply turn on bluetooth on your device and search for "Joyonway" Bluetooth password 2288.

VALVES INFORMATION

Spa offers your various massage modes. Please try to find your suitable model: adjust the diverter valves, the air regulating valves and jets, and open or close one of the jet pumps. Please find the equipments instructions below. (if fitted)

Diverter Valves (If fitted)

Diverter valves allow you to guide the water from the jet pump to different jet combinations. By the following test, you can fully understand the function of these diverter valves.

1. Open the all pumps & all of the air regulating valves into the open position.
2. Turn the switch of every diverter valve and view which jet combination is controlled. (You can adjust the diverter valve to any position between two possible ends to get the best jet pressure you need).

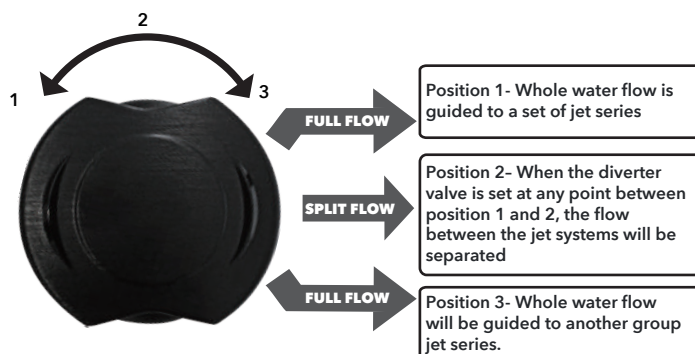

Important: When the diverter valve is in the "middle" position, from the design perspective of the spa, the jets can not provide the maximum pressure. You can turn the switch to close the unused jet, in order to increase the pressure of the selected jet.

Waterfall Valves (If fitted)

When spa is equipped with a waterfall device. To start this device, please turn the control valve once or more times until the waterfall appears. By opening the control valve on the spa surface, you can adjust the waterfall flow.



Air Regulating Valves (If fitted)

Air control function allows you to enjoy massage with different pressures from the jets.

Each jet system has its own control device. By opening the control valve on the spa surface, you can control the jet pressure through adjusting the air amount in the water flow.



Aromatherapy Dispenser (If fitted)

On the lip of your spa there is a screw cap, by adding specially formulated Aroma beads into the dispenser, beautiful scents are infused into the spa via the bubbles, enhancing relaxation and overcoming chemical smells. The scent is drawn into the water when the blower is activated. When the scent becomes faint simply replace the Aroma beads. Contact and purchased through your Authorised Spa Dealer.



JETS INFORMATION

Your new Spa has several different types of jets, with different massage actions. Follow the diagrams for correct operation of your jets.

Note: Turning off too many jets may cause water to syphon out of the Air Venturi's.

Hurricane Jets

The Large Hurricane Jets are interchangeable with each other. Move them around to suit your massage type. Simply turn the jet clockwise / counter clockwise to turn water flow on /off. To remove jet face, turn the jet face counter clockwise until the face clicks out.



Mini Hurricane Jets

The Mini Hurricane Jets are interchangeable with each other. Move them around to suit your massage type. Simply turn the jet clockwise/counter clockwise to turn water flow on/off through the jet. To remove jet face, turn jet face counter clockwise until the face clicks out.



Micro Hurricane Jets

The Micro Jets are designed for a strong massage effect with a small jet face. (These jets are not able to be turned off).

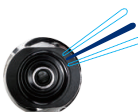

SPA MAINTENANCE

You are responsible for the maintenance of your spa.

Cleaning The Spa Shell

Ensure spa is not continually exposed to the elements, the acrylic shell can reach very high temperatures if the spa is located without shading or cover. Damage due to sunlight or extreme temperatures is not covered by the Spa Warranty. Exposure to the elements while not filled with water, while hardcover is removed or by simply no shading of the spa may cause damage to the acrylic shell. With normal use of your spa, oils, lotions and hairsprays will build up on the surface of the water sometimes leaving a scum line around the perimeter of your spa shell.

Use a recommended cleaner or simply wipe down with a soft cloth and a non-abrasive cleaner. (eg methylated spirits). Clean while spa is drained for servicing or water change-over.

For hard water stains consult the Authorised Spa Dealer for an acceptable spa cleaner/polish.

- Never allow your spa surface to come in contact with acetone (nail polish remover), nail polish, dry cleaning solution, lacquer thinners, gasoline, pine oil, abrasive cleaners, citrus cleaners or any other harsh chemical. These chemicals can damage your spa shell and void your warranty.
- Do not use cleaning agents that will leave suds in your spa water.
- Adjustable jets should be removed and washed thoroughly to remove any dirt and grit build up. (Removal of jets is outlined in the jet section)

Note: Minor scratches can be removed by using fine wet & dry sandpaper and car polish.

Contact your Authorised Spa Dealer before attempting this method.

Maintaining The Spa Hardcover

1. When cleaning your cover, use a mild soap and water.
2. Do not walk, jump or lie on cover.
3. When moving your cover, lift at all times, do not drag, drop or slide cover.
4. Do not lay cover on rough surfaces.
5. Approximately every four weeks, use an approved vinyl conditioner on top of the cover.
6. Remove foam liner from Hardcover every 12 months and rotate to eliminate aging of the hardcover.

It is most important that you connect the lock-down clips to the cabinet to ensure safety for your family. Ensure hardcover is fitted on spa at all times when not in use.

Using a spa hardcover any time when the spa is not in use will significantly reduce your operating costs, heat up time and maintenance requirements.

Note: Damage to spa caused by the elements due to hardcover not being used correctly will void warranty.

Cleaning Your Filters

You should clean your filters regularly. Once a week you should remove your filters and hose any debris out of them with a high pressure hose. Once a month you should soak your filters in a cartridge filter cleaning solution and then hose off with a high pressure hose.

Cartridge filters are made from fine polyester paper like material, specifically designed to filter out body oil and grime. Your spa is equipped with easy access skimmer cartridge filters. The average life expectancy of a cartridge filter is approximately 12-18 months (with proper care and correct water maintenance).

It is recommended that the filters need to be cleaned every week to remove all body oils and grime from the surface (cleaning intervals dependent on usage)

Replacement cartridge filter may be purchased from your Authorised Spa Dealer. (It is recommended that you purchase a second set of filters).

How To Remove Cartridge Filter Elements

1. Turn power off to spa from circuit breaker or isolation switch. Ensure power is turned off during cleaning of filters as foreign matter can make its way into the pumps, heater and plumbing system while filters are removed. Please refer to the diagram below.

Single-Port Enclosed Filtration System	Two-Port Enclosed Filtration System	Two-Port Filtration System	Curved Mesh Filtration System
<div><div>(1) Filter Plate</div><div>(2) Filter Box</div><div>(3) Filter Basket</div><div>(4) Cartridge Filter</div></div>	<div><div>(1) Filter Plate</div><div>(2) Filter Box</div><div>(3) Filter Basket</div><div>(4) Cartridge Filter</div></div>	<div><div>(1) Filter Cover</div><div>(2) Filter Plate</div><div>(3) Filter Basket</div><div>(4) Cartridge Filter</div></div>	<div><div>(1) Filter Cover</div><div>(2) Filter Plate</div><div>(3) Cartridge Filter</div></div>
<div><div>1. Pull up the Filter Plate(1).</div><div>2. Take out the Filter Basket(3).</div><div>3. Take out the Cartridge Filter(4).</div><div>4. Clean or replace the Cartridge Filter.</div><div>5. Press the Filter(4) down in its place.</div><div>6. Push the Filter Basket(3) in its place.</div><div>7. Install the Filter Plate(1).</div></div>	<div><div>1. Pull up the Filter Plate(1).</div><div>2. Take out the Filter Basket(3).</div><div>3. Take out the Cartridge Filter(4).</div><div>4. Clean or replace the Cartridge Filter.</div><div>5. Press the Filter(4) down in its place.</div><div>6. Push the Filter Basket(3) in its place.</div><div>7. Install the Filter Plate(1).</div></div>	<div><div>1. Pull up the Filter Cover(1).</div><div>2. Take out the Filter Basket(3).</div><div>3. Take out the Cartridge Filter(4).</div><div>4. Clean or replace the Cartridge Filter.</div><div>5. Press the Filter(4) down in its place.</div><div>6. Push the Filter Basket(3) in its place.</div><div>7. Install the Filter Cover(1).</div></div>	<div><div>1. Pull up the Filter Cover(1).</div><div>2. Take out the Cartridge Filter(3).</div><div>3. Clean or replace the Cartridge Filter.</div><div>4. Press the Filter(3) down in its place.</div><div>5. Install the Filter Cover(1).</div></div>

2. After removing the cartridge filter, please clean with the high-pressure jet to remove all debris clinging to the element.
3. Before re-starting the jet pump, please check whether the filtration system is perfectly installed.
4. Soak filter in a recommended cartridge filter cleaner to remove all body oils and grime.
Check with cartridge cleaner instructions.
5. Thoroughly rinse cartridge with clean water using a high-pressure jet again.
6. Replace filters - Be careful not to over tighten.
7. Replace filter basket and faceplate.

Important: When you remove your filters, ALWAYS ensure that the power to your spa is off before doing so! If you leave your power on and anything is drawn into your pump or heater, causing either to fail, fault will not be covered under warranty.

Jet Maintenance

If you find that the jet rotation speed is slower than a new spa, or the jet is sticky, the reason could be the accumulation of sediment in the jet bearings. To remove the sediment, please follow these instructions:

- Close the spa, rotate the jet panel, until the rotation of the panel stops.
- When the panel stops to rotate, please continue to rotate it counterclockwise with a larger force and let the panel pass the locking position, until the panel stops again. Pull out the panel and let the entire jet leave the spa.
- After washing the bearing in the jet with water, turn the rotary eye. Now, the jet should be able to rotate freely. If it can still not freely rotate, you can soak the bearing in a cup of vinegar for one night (cider vinegar can soften any sediment). Wash the bearing with water on next day and then carry out a rotation test.

Note: If the bearing can still not freely rotate, you need to soak it one night more. If the bearing still does not rotate, you must purchase a new one by the dealer.

- To replace the bearing, please put the bearing opening down to the panel rear end and push the panel into the spa. Gently rotate the panel in either direction, until you feel that the panel is aligned with the device. Then press the panel into its place, then rotate the panel with a little larger force clockwise and let it pass the lock position. If the panel does not rotate, please remove the entire panel, rotate it in 180°, and repeat this step. After opening the jet pump, the jet should be free to rotate.

Diverter Valve Maintenance

If the diverter valve of your spa is difficult to rotate, the reason could be the accumulation of residues in the valve. Please remove such residues as soon as possible to prevent damage to the diverter valve. In order to do this, please follow these steps:

- Switch off the breaker on the panel to shut off the power supply to the spa. Lift and shake back and forth to remove the diverter valve handle.
- Pull up and remove the valve body.
- Wipe the valve body and the valve inner wall.
- Lubricate the O-ring with waterproof lubricants delivered by your dealer. Reinstall the diverter valve and turn on the power to the spa.

Headrests

Most spa models have 2-7 moulded comfort pillows / headrests. These headrests are designed for comfort to the spa user.

We recommend removing these headrests periodically to clean behind them. We also recommend removing the headrests if your spa is not going to be used for a long period of time, as consistent exposure to chemicals, ozone and moisture may damage the product over time.

Every 3-6 months the headrests should be removed for cleaning. The headrests are secured to the shell by small snap in lugs, or are simply a slide fit, this prevents the headrest from falling into the spa.

Headrests can be wiped with methylated spirits, then coated with a high grade vinyl rejuvenator to rejuvenate the faded, powdered look.



Spa Cabinet

When cleaning the spa cabinet, you can only use a soft cloth or sponge dipped in neutral soapy water. Abrasive cleaners or applicator agents will damage the surface gloss. The spa cabinet must be thoroughly cleaned with clear water.

Chemicals For Your Spa

Sanitiser is extremely important for killing algae, bacteria and other unwanted impurities in spa water. First test the water using one of our testing kits to know the water situation, to confirm if sanitiser needs to be added. Second, open the filter, take out brominator, and put chlorine or bromine inside to reach recommended Alkalinity to 125ppm, calcium hardness to 150mm, pH to 7.2-7.6 prior to each use.

Sanitising Your Spa

Proper sanitisation of your spa is important. Ensure you maintain residual sanitiser levels to product recommendations. Make sure you adjust your alkalinity level first as an out-of-balance condition will affect ability the pH correctly. And will prevent the sanitiser from operating effectively. Use test strips to measure your sanitiser levels.

Changing The Water

Approximately every 8-12 weeks, or more frequently depending upon usage, you should completely drain your spa. About 1/3 of the water capacity should be drained off every month in addition to the above procedure to keep the water manageable. The frequency of complete drainage depends on a number of variables including the amount of use, attention paid to water quality, maintenance etc. You will know it is time for a change, when you cannot control foaming and/or you can no longer get the normal feel or sparkle to the water even though the key water balance measurements are all within the proper parameters.

If you use your spa once or twice a week, then need to drain your spa will be less frequent than a spa owner who uses their spa three or more times a week. Therefore, it would be recommended that a spa be drained at least every 8-12 weeks.

Note: Be sure the power to your spa is turned off before draining.
Damage to equipment due to dry running is not covered under warranty.

When Your Spa is Not in Use

If you are going away for a period longer than 2 months, it is recommended that you turn your spa off and empty it. It is important to remember to leave the cover on even while empty to protect the shell. If you are going away for a few days or weeks, do not turn your spa off completely. Turn the temperature down to 15°C, so that the filtration cycles are still functioning but the spa doesn't heat.

NOTE: AT NO TIME SHOULD YOU LEAVE YOUR SPA IN DIRECT SUNLIGHT FOR PROLONGED PERIODS OF TIME. PLEASE MAKE SURE YOU PLACE THE COVER BACK ONTO THE SPA AFTER EVERY USE OR CHEMICAL APPLICATION. FAILING TO COVER YOUR SPA FROM DIRECT SUNLIGHT MAY DAMAGE YOUR SPA SHELL AND VOID ALL WARRANTY.

IF WATER QUALITY IS POOR: Clean filters, test and balance water and run spa for an hour.

EVERY TIME YOU EMPTY YOUR SPA: Remove and clean the jets if stiff or scratchy.
If jets do not turn or spin, this is due to chemical build up and/or sand/grit behind them.

To adjust the water flow to fully open position on the exhilarator and excess spa jets, simply rotate the jet face in a counter-clockwise direction until you come to a stop. Your spa jet is now operating at full pressure.

Please contact your Authorised Spa Dealer for suggested water treatments.

Winter Preparation

Your spa is specifically designed and suitable to any climatic conditions. Therefore, you can use it throughout the year. In some areas, extremely cold (below -12°C or 10°F) with the strong wind is "hand in glove", even the water in the spa is kept at a selected temperature, the jet pump could partial freeze. In cold weather, the heater starts more frequently, that will result in reduced energy efficiency of the spa. In order to prevent partial freezing of certain components, the spa cabinet can be insulated with an insulation device (available from your local dealer). This insulation device can also help maximize energy efficiency of the spa.

Note: When the weather is warmer (temperatures of about 16°-21°C or 60-70°F), the insulation device must be removed to prevent overheating of the jet pump.

When the spa is not used in the cold winter for a long time, the water should be fully drained for winter preparation, in order to avoid unexpected freezing caused by power outages or equipment failure. Please follow the instructions below.

▲ Dangers: Please only use non-toxic glycol to prevent freezing (available from most RV or marine supplies store). Never use automotive antifreeze (ethylene glycol), because it is toxic!

- Drain water from the spa according to the section "Drain your Spa" in this User manual.
- Remove the cartridge filter and then store it in a dry place.

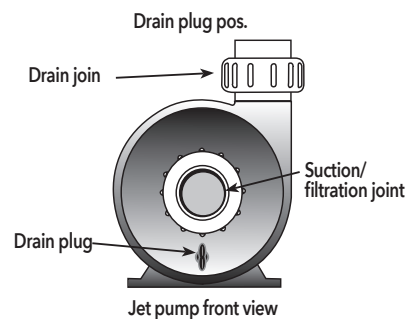

DRAIN YOUR SPA

- Find the main drainage. According to the procedure shown in the Figures B, remove the core of drain valve, connect the external water hose to the garden hose connector (to avoid flooding the foundation around the spa) and push the hose inwards to the garden hose connector and then pull the hose to a proper drainage area.

Note:

- Please don't bend the drain hose to avoid influencing drainage.
 - The water containing higher concentration disinfectant is harmful to programs and lawns.
 - The water can drain almost completely by through the drain valve all spa type. The water in jet pump, heating system and other equipment will also be discharged. The residual water in the pipe or equipment needs only to be discharged, when conducting the winter preparation.
- After drained water, please clean the tub and cartridge filter.
 - Pull out and remove the drain hose and garden hose connector, place the core of drain valve into the spa again as shown in the Figures A.
 - Fill water according to "Procedure of Filling Your Spa & Starting Up".



Figures A

Garden Hose Connector: We have 2 different types garden hose connector, and it is usually putted in the filtration box. Choose the suitable connector according to the actual situation.



Garden Hose Connector 1



Garden Hose Connector 2

Step 1

Turn counterclockwise to remove the core of the drain valve.

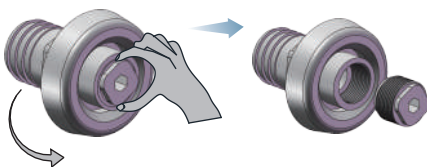

Step 3

Connect the garden hose connector with an external water hose.

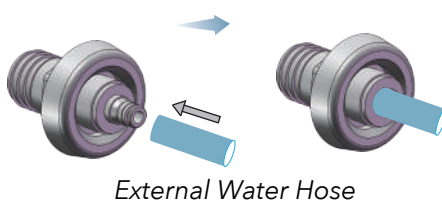

Step 2

Connect a garden hose connector to the drain valve.

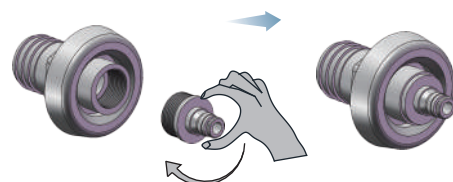

Step 4

Rotate the outer circle of the drain valve counterclockwise to drain.

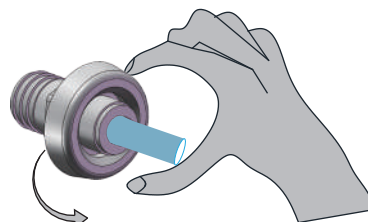

Figures B

WATER QUALITY & MAINTENANCE

General Information

Three Aspects For Water Quality Maintenance:

- Filtration
- Chemical Regulation/pH Value Control
- Disinfection

The users have the responsibility to maintain the water in health status and regularly add qualified disinfectant to the water (if needed, add it every day). Through chemical methods, you can control bacteria and viruses in the tap water or in the water after using the Spa. Without disinfection, bacteria and viruses will increase rapidly.

The users have also responsibility to adjust the water through chemical method and to control the water pH value. You must add chemicals to the water and make the water total alkalinity (TA) \ calcium hardness and pH value maintain normal levels. The correct water regulation and control of the water pH value can minimize the scale accumulation and corrosion of the metal, so that the life of the Spa is extended and the disinfectant can play the best effect.

Water Test Method

Correct test and analysis of the water quality is an important measure for effective maintaining water quality. In accordance with the recommended program, you must check:

- Total alkalinity (TA)
- Calcium Hardness (CH)
- pH Value
- Disinfectants

Recognizes and recommends the following two test methods:

- Test with reagent is a method of higher accuracy. The agent can be in liquid or tablet form.
- The test with test paper is a simple method and many spa users use this method. Please remember that the test paper is sensitive to heat and moisture, and a heated or damped test paper can lead to inaccurate readings

Note: Please read and strictly follow the operation instructions in the test paper box to ensure accurate test results.

Basic Chemical Safety

When using chemicals, please read and strictly follow the operation instructions. Correct use of the chemicals can protect you and your spa. But high content of chemicals is harmful. Please follow the following principles:

- Only reliable adults are allowed to treat the spa chemicals. Chemicals should be placed out of reach of children.
- Accurately take and use the prescribed dose to the spa, not too much.
- All containers are to be handled with care and to store in a cool, dry, well ventilated place.
- Chemical containers must be sealed with corresponding covers, when not in use.
- Don't breathe fumes or allow chemicals touching eyes, mouth and nose. Wash hands immediately after use.
- In case of accidentally touching or swallowing chemicals, you must be treated in accordance with emergency treatment recommendations given on the product label. At this time, you have to call a doctor or your local poison control center. For medical treatment, please carry chemical containers in order to determine the composition of the chemicals.
- Don't let the chemicals drop onto the surrounding ground or green plants.
- Don't remove the dropped chemicals with the vacuum cleaner.
- Don't smoke near chemicals. Some chemical fumes are highly flammable.
- Don't store chemicals in the spa cabinet.

How To Add Chemicals To The Water

Important: All spa chemicals, including the sodium dichloro cyanurate exc disinfection powder, MPS (monopersulfate), powdered pH value - increasing agent and inhibitors, powdered total alkalinity - increasing agent, calcium hardness- increasing agent, descaling liquid and defoaming liquid, must be added directly into or before the filtration box during the operation of the jet pump, which must run at least 10 minutes.

To Add A Water Treatment Agent:

- Fold the spa cover. Carefully remove the filtration box cover and set it aside (to use timely).
- Find the button "clean" on the control panel and start the jet pump.
- Carefully take a recommended dosage of chemical and slowly pour it into or before the filtration box. Don't let the chemical sputter onto hand, eye, tub or tub sidewall.
- Replace the filtration cover (if any). After 10 minutes, turn off the jet pump, close and lock the cover.

Drowning danger: monitoring is necessary, while the spa is open!

▲ Warning: If the disinfectant concentration is too high, this could lead to discomfort of the eyes, lungs and skin of the users. Before using the spa, please remember to let the disinfectant concentration to the recommended range. Important note about the "superchlorination/non-chlorine oxidation treatment": after the spa has been treated through superchlorination or non-chlorine oxidation, the spa cover should be open for 20 minutes to discharge the oxidizing gas. If the high concentration oxidizing gas produced by oxidation treatment (not daily disinfection) is not discharged, this could gradually lead to a discoloration of the cover back or degradation of the vinyl basic material. Such damage is considered as chemical misuse and will not be covered under the warranty.

Water Quality Maintenance Program

In according to the water quality maintenance program, each step must be done after completing the previous step. If one step is ignored or does not meet the proposed standard, it could lead to a water chemistry imbalance. This will damage the spa tub and its components, and makes the user discomfort.

Total Alkalinity (TA) Adjustment

- Water total alkalinity (TA) is 125-150ppm.
- Total alkalinity means a metrics of the total content of carbonates, heavy carbonates, hydroxides and other alkaline substances in the water and is called as "pH buffers", that is the metrics of the ability of water to prevent the pH value change.
- If the total alkalinity is too low, then the pH value will largely fluctuate from high to low. pH value fluctuations can lead to corrosion or scaling on the spa components. If the total alkalinity is too low, it can increase by adding sodium bicarbonate (pH value/ alkalinity increasing agent).
- If the total alkalinity is too high, the pH value tends to be higher and is difficult to reduce. It can be reduced by using sodium bisulfate (pH value/alkalinity inhibitors).
- Once the total alkalinity of water reaches balance, it will usually remain unchanged - although the reading will increase and decrease after adding the water with high or low alkalinity otherwise.
- You can carry out the next operation, after the total alkalinity has entered into the recommended range.

Calcium Hardness(CH) Adjustment

- Recommended water calcium hardness (CH) is 125-150ppm.
- Calcium Hardness is a metrics of the total content of calcium dissolved in the water. Calcium helps control the water causticity. Therefore, we don't recommend low calcium water (which is usually called as "soft water"). The low calcium water is strong corrosive to the equipment and can lead to scaling on the spa tub surface and equipment.
- If the calcium hardness is too high (which is usually called as "hard water"), it will lead to scaling on the spa tub surface and equipment. The calcium hardness can be reduced by dilution method - the calcium hardness can usually falls to the correct range by mixing 75% of the hard water with 25% soft water. If the soft water is not available or not applicable, you should add detergents to the water (according to label instructions of the detergents).
- If the calcium hardness is too low, then add calcium hardness increasing agent.
- Once the calcium hardness reaches balance, it will usually remain unchanged - althrough the reading will increase and decrease after adding the water with high or low calcium content otherwise.
- You can carry out the next operation, after the calcium hardness has entered into the recommended range.

pH Value Adjustment

- The ideal water pH value is 7.2-7.6.
- The pH value is a metrics of acidity. When the pH value is more than 7.6, the water is alkaline, when lower than 7.2, the water is acidic. Maintaining the proper pH value is of great significance.

So you can:

1. Optimize the effectiveness of disinfectants.
 2. Keep the water use comfort.
 3. Prevent aging equipment.
- If the pH value of the water is too low, it may results in the following consequences:
 1. The rapid consumption of disinfectant.
 2. Users have allergies.
 3. Corrosion of the spa equipment.

Note: If the pH value is too low, you can add sodium bicarbonate to the water(pH value/alkalinity increasing agent).

- If the pH value is too high, it may results in the following consequences:
 1. Reducing the effectiveness of disinfectants.
 2. Scaling on the surface of the spa tub and equipment.
 3. The water becomes turbid.
 4. Blocking of the filter pores.

Alkaline water (scaling zone)	8.2	Add pH inhibitors to reduce pH value
	7.8	
Comfort Zone	7.6	Ideal range
	7.4	
	7.2	
Alkaline water (Corrosion zone)	6.8	Add pH inhibitors to reduce pH value
	pH	

Note: If the pH value is too high, you can add sodium bisulfate (pH value/alkalinity inhibitors) to the water to reduce the pH value.

- Regularly (once a week) check of the pH value is of great significance. All of the use frequency, the situation of adding the fresh water and various chemicals as well as the kind of disinfectants will influence the pH value.
- You can carry out the next operation, after the pH value has entered into the recommended range.

Keep The Concentration Of Disinfectant

- In killing algae, bacteria and viruses and preventing the proliferation of harmful microbes in the spa bath proliferation, disinfectants play an extremely important role. But excessive use of disinfectants is not allowed, because this can irritate the skin, lungs and eyes.
- The disinfectant concentration should always be maintained at recommended level.
- Recommends only the use of dichloroisocyanuric acid sodium (sodium bichloride or sodium chloride) as disinfectant.

▲ Warning: Please don't use trichloroisocynurate, bromo-chloro-dimethyl hydantoin (BCDMH), or any bromine or chlorine in solid form, acid or any kind of disinfectants that is not recommended.

Water Quality Maintenance Quick Reference					
Step		Ideal range (PPM)		Chemicals used	Inhibitors
		Minimum	Maximum	Increasing agent	
1	Total Alkalinity	125	150	Sodium bicarbonate or baking soda	Sodium bisulfate
2	Calcium Hardness	150	200	Calcium hardness increasing agent	Mix 75% hard water with 25% soft water, or use detergents
3	pH Value	7.2	7.6	Sodium bicarbonate	Sodium bisulfate
4	Disinfectants	See the section "Keep disinfectant concentration"			

Water Treatment System

Water treatment system consists of the following products:

- Minerals cartridge filter
- Sodium bichloride
- Chlorine-free oxidizer (monopersulfate)
- Corona discharge(CD)ozone generator

Minerals cartridge filter is used for adding chemicals to the water, in order to inhibit the growth of bacteria. This can oxidize particles in water when using together with chlorine-free oxidant (monopersulfate).

Note:

- When using various types of products, please remember following the recommended application and maintenance program. You need to increase the amount of disinfectant after the spa has been used for a long time (such as an entire afternoon or evening).
- "Oxidation treatment" is required once a week, that can quickly destroy residual dirt and restore the vitality of bromine in the water.
- "Oxidation treatment" is required once a week, and the frequency of the oxidation treatment has to increase, if the spa is used more frequently.

Replacement Instructions For Cartridge Filter

Minerals cartridge filter should be replaced once four months. When replacing the minerals cartridge filter, we strongly recommend to drain the water completely and then re-add the water. Then adjust the total alkalinity (TA), calcium hardness (CH) and pH value to the recommended level. Add chlorine-free oxidant for oxidation treatment.

Note: By replacing the cartridge filter, please refer to the instruction of previous “Clean Your Filters”.

Chloride (Sodium Bichloride)

- Chemical disinfectants such as chlorine, are oxidants used to kill bacteria and germs in water. The free residual chlorine (FAC) means the measurable chlorine amount remaining in the water, that can be used for disinfecting the spa.
- We recommend using chlorine particles of sodium bichloride for water disinfection, because sodium bichloride can be completely and rapidly dissolved in water and its pH value is close to neutral.
- During use, it is extremely important to maintain the proper level of chlorine.
- If the content of the free residual chlorine (FAC) is too low, bacteria and viruses in the warm water can grow rapidly. Please increase the free residual chlorine (FAC) by adding sodium bichloride articles.
- If the content of the free residual chlorine (FAC) is too high, the water in the spa can irritate the eyes, lungs and skin. The content of the free residual chlorine (FAC) is automatically reduced after waiting for some time.
- When free residual chlorine (FAC) keeps in the recommended range, you can safely use the spa.

▲ Warning: Many kinds of stabilized chlorine can be used for a spa or swimming pool and each kind has its specific chemical properties. It is extremely important to select a spa-special chlorine. Incorrect use of trichloro with a very low pH value (pH2.6, too fast dissolving in the water resulting in a very high chlorine content, specifically for concrete or pool) will damage your spa. Your spa could be damaged by using liquid or solid bromine, chlorine, acid or any kind of disinfectants other than our specification. This damage will not be covered under the warranty.

Chlorine measured readings with DPD reagent or test paper	Before the reading drops below this level, the use of the Spa is forbidden
5.0 —	Recommended security level by DPD reagents
4.0 —	
3.0 —	Adding chlorine
2.0 —	
1.0 —	Adding chlorine during the use of the Spa is forbidden
0 —	

Important: By improperly storing, the granular form chlorine (sodium bichloride) will be decomposed. We recommend the purchase and use the chlorine in 1 pound, 2 pounds or 5 pounds package. To maintain performance, please store it in a cool and dry location.

Superchlorine

Superchlorination applies specially for "burning" the accumulated chloramine (waste chlorine) to eliminate the chlorine odor and keep the free chlorine to a proper level. When conducting the water superchlorination treatment, please open at least a half of spa cover, in order to facilitate the chlorine emission. Superchlorination (non-daily disinfection) may lead to a too high chlorine concentration resulting in discoloration or degradation of the cover back. Such damage is not covered under the warranty.

▲ Warning: Don't let the spa in unattended status, especially when children are present!

Water Treatment Guidelines	
When starting Spa or adding water	Follow the instructions of the section "Filling Your Spa & Starting Up".
Before each use (Please test before adding any chemicals: if you find that the content of the chemicals is correctly or higher, don't add any chemicals)	Add ½ tablespoon of sodium bichloride to every 950 liters (250 gallons) of water or 1 tablespoon of monopersulfate to every 950 liters of water.
Once a week	Add 1.5 tablespoon of sodium bichloride to every 950 liters of water or 3 tablespoon of monopersulfate to every 250 liters of water.
Every four months	Drain the water completely; replace minerals cartridge filter and re-adding water according to the instructions in the section "Filling Your Spa & Starting Up".
When necessary (If the water becomes turbid has or peculiar smell)	Add 1.5 tablespoon of sodium bichloride to every 950 liters of water.

Make Daily Disinfection Plan

In the first month of use, please measure the residual amount of disinfectant every day, in order to determine the demand standard of the cartridge filter and disinfectants according to different frequency and time of use.

- Use frequency: Refers to the person-time entering into a spa.
- Use time: Refers only to the use time of a single person.
- Disinfectant demand refers to the quantity of disinfectants required by user number and total use time.

For example, two persons regularly use the spa, one time per night and 20 minutes each time. In this case, the disinfectant demand is relatively clear and generally fixed. In the first month of use, the two users can accurately determine the required quantity of disinfectants to maintain proper residual chlorine. If the use frequency/use mode changes greatly in a certain period of time (for example inviting guests), then the disinfectant demand and frequency of adding disinfectant will greatly increase. The longer the use time and the more the use frequency is, the faster the residual chlorine value reduces.

Precautions

- Check the content of bromine disinfectants before each use.
- Replace the FROG minerals cartridge filter once every four months.
- Test the total alkalinity and pH value once a week.
- Use only the non-chlorine (monopersulfate) oxidizant.
- All chemicals must be sealed and placed in a cool and dry place.
- The use of sodium bromide or biguanides is forbidden. These are active disinfectants, that can compound with silver ion and lead to losing efficacy of the disinfectants.
- Use of water purifying agent is forbidden, as it can cause water turbidity.

Water Quality Maintenance Supplementary Program

In a complete water maintenance program, proper water quality hygiene and minerals balance (pH value control) is essential. There are another three optional common additives for the water treatment as follows:

Mineral Deposition Inhibitor

- With the water evaporation and adding fresh water, the amount of dissolved minerals will increase. (Cover the spa as much as possible to minimize water evaporation.) Water will eventually become "hard"(calcium hardness is too high) to lead to damaging the heater surface due to calcification. Proper pH value control can minimize this possibility.
- Under normal circumstances, the soap will be piled up more and more. Therefore, it is necessary to replace the water regularly. The mineral deposition is usually not a problem.
- Sometimes, the content of iron and copper in the water is higher and this may produce green and brown spots on the spa tub. In this case, detergents may help to reduce these metals.

Note: The content of minerals in the well water is higher. A low flow water filter with ultrafine pores can help filter out many of the larger particles.

Foam Inhibitors

- Because the soap will be piled more and more in the water, so the water needs to be replaced. Generally, when using jets, the soap can cause foaming of the water. Soap comes into the spa in two ways: the user's body(residual soap after the shower) and swimwear (residual soap after washing).
- Foam inhibitors can inhibit foams, but can not eliminate the existing foams from the water. Soap can never be oxidized by chemicals added to the water and is therefore difficult to be removed from the water. Only ozone can oxidize soap.
- At last, soap will accumulate to higher concentrations in the water and lead to skin discomfort of the users. This is impossible to remedy. In this case, please drain out the water and fill fresh water into the spa. Freshwater should be able to be used for four months, but depending on the input amount of soap.

Ozone System

- Ozone system is the ozone purification system installed after license on the spa. Efficient ozone system uses "corona discharge" (CD) technology. Compared with the same kind of ultraviolet (UV) ozone systems, it is capable of producing higher concentrations of ozone.
- This efficient ozone system uses hidden installation, not only more subtle, but also not easy to be influenced by the freezing temperature. When servicing ozone system, please remove the spa cabinet and check the operation of the equipment (usually, this operation should be carried out before disconnecting power of the spa to draining water). As long as you hear the hum of the transformer, you can determine that the efficient ozone system is working properly.
- As a complement measure to the regular maintenance of water quality program. Efficient ozone system can greatly improve water quality. In contrast with some wording about the ozone system from mouth to mouth by some people in the swimming pool and spa industry. Ozone can not be used along for disinfection, water purification, anti-foaming and chelating minerals. We recommends, if you ensure the water hygiene and the highest quality of purified water by using ozone purification system, you should still develop a chemicals maintenance program accordance with the written and accepted standard in the industry and comply with it.

Clean Of The Ozone Jet

Sometimes, the ozone jet can be blocked due to mineral accumulation, that will lead to interruption of the ozone bubble flow or lower speed of the ozone bubble flow. In order to prevent this situation, please clean the jets in according to the following instructions:

- Cut off the power of the spa.
- Open the spa cabinet.
- Take a container (such as a bowl or bucket), pour 0.5 liters of white vinegar into the container, and then place the container on the floor of the equipment compartment.

Note: White vinegar will not damage any part of the spa.

- Carefully loosen the long transparent hose connected to the ozone generator bottom. There may be some liquid in the hose. If so, please don't touch this liquid. You should insert one hose end into the white vinegar, until it touches the bottom of the container.
- Reconnect the spa power.
- Start the spa, until all 0.5 liters of white vinegar is completely pumped. This allows enough white vinegar to flow through the jet and clear the blockage.
- Cut off the power of the spa.
- Take out the empty container.
- Reconnect the hose to the bottom of the ozone generator.
- Close the spa cabinet.
- Reconnect the spa power.

Ozone system is located inside the spa cabinet and needs almost no maintenance. But when bubbles appear in the backwater of the heater and the water is not as clear before, you need to check whether the ozone generator works properly. Carefully open the spa cabinet (please be careful, because the spa is still powered) and confirm the normal operation of CD tube and its transformer (ozone generator housing will make a slight hum). If you don't hear the slight hum, please confirm that the generator has been connected fully with the control box of the spa.

▲Warning: If the fault to be treated is beyond the scope of this manual, please contact dealers. Ozone system can be repaired only by qualified technicians.

Important : Ozone jet cleaning does not belong to the warranty scope. Please refer to the above mentioned "Clean Of The Ozone Jet" instructions.

Precautions

- The use of acid and hydrochloric acid to reduce the pH value of the spa and swimming spa is forbidden.
- It is forbidden to splash the pH value increasing agent into the wall.
- The use of solid disinfectant is forbidden.
- It has now proved that the use of flotation devices containing bromine sticks or bromine flake may cause discoloration or damage of the tub surface, because the floating device may fall into the bottom seats or loungers (or sink to the spa bottom).
- Although the floating disinfection system is a low-maintenance or even maintenance-free solution, but it is not suitable for the spa maintenance program.

Spa tub can easily resist the influence of correctly distributed disinfectants. Non-floating dispensers could be concentrated in one area leading to excessive disinfection in this area (or chemical burn).

If the position of the dispensers is too high, the high concentration disinfectant can lead to discoloration of the spa tub and damage to the cover back.

Because of the extremely large change of the decomposition speed of chemicals great, the automatic floating dispensers could result in insufficient or excessive bromide and lead to quick damage to the spa tub and cover.

Note: Recommends not using any floating dispenser. The damage to the spa tub or parts caused by the floating dispensers belongs not to the limited warranty range.

- All chemicals must be added slowly to the filtration box before filtration box and let the jet pump run 10 minutes in the same time.
- Please be particularly careful by cleaning the inner and outer plastic surfaces with baking soda. The use of non-specific spa disinfectant is forbidden.
- The use of household bleach (sodium hypochlorite solution) is forbidden.
- Spraying chemicals onto the water surface is forbidden. This method will cause bubbling on the tub surface because the chemical reaction (chemical misuse).
- It is forbidden to use the granular bromine disinfectant together with ozone.

General Problems About The Water Chemical Properties

Question: Why do you not recommend the water disinfection with the floating device?

Answer: Does not recommend the floating disinfection with the floating device for three reasons:

- The floating device is unable to control the speed of the disinfectant dissolved in water. When the floating device has just been placed in a spa, the concentration of the disinfectant could be extremely high and lead to chemical burns or discoloration on the spa tub or cover back. After some time, the concentration of disinfectants distributed through the flotation device will drop almost to zero. Low concentration of disinfectants will not inhibit the growth of virus, bacteria or algae.
- Floating devices shall be sometimes concentrated in an area (typically stay on chairs) and lead to damage to this area due to the contact with the disinfectants with a high concentration.
- The disinfectants with a high concentration could splash from the floating devices and fall onto the floor or base of the spa. The disinfectants could lead to chemical burning (bubbling) on the spa tub. The spa tub is specifically designed and is able to withstand the influence of chemicals, but no spa surface can bear the highly concentrated chemicals.

Please remember, the misuse of chemicals is especially not covered by the warranty range.

Question: When smelling the chlorine odor by opening the spa cover, how to remove it?

Answer: There are two forms of chlorine in the spa.

- The first one is free residual chlorine, which can be used for disinfection of the spa. This free residual chlorine is odorless.
- The second is chloramines, which is the residue of chlorine consumed. Chloramines have a strong chlorine odor. Through a water "oxidation treatment", you can eliminate the odor of chloramines. When the water has a chlorine odor, it means you need to add the oxidation agent.

Question: Why it is not allowed to add the soft water to the spa?

Answer: Soft water and normal water is basically the same, but the calcium in the soft water is mostly (or even fully) replaced by sodium. Soft water may corrode the heater and other components. If a spa component was damaged by soft water, the replacement is very expensive.

Question: I want my family to touch chemicals as less as possible. So many kind and so large doses of chemicals are really needed?

Answer: More touching of any chemical is harmful to the human body. But many chemicals at lower concentration have a good function. For the spa water, chemicals recommended by CALDERA water quality maintenance program are required, in order to protect the users from hazards of aquatic pathogens (disease-causing microorganisms), while preventing corrosion of the spa components.

Question: Why the chemical damage belongs not to warranty scope?

Answer: The water quality and the concentration of chemicals stay under your direct control. Through appropriate basic maintenance, the spa can provide you warm water wellness enjoyment for many years. If you have a lack of understanding of any chemicals and their use in the spa, you can contact your authorized dealer.

Terms Related To Water

In the "Water Quality And Maintenance" section, following terms are used. Understand its meaning will help you better understand water quality maintenance measures.

Bromamine: The compound produced by the combination of bromine with nitrogen from skin oil, urine and sweat. Different from chloramine, bromamine has no irritating odor and is a highly effective disinfectant.

Bromine: Halogen disinfectant (the same kind of chemistry with chlorine). Bromine is usually made in the form of rods, flakes or granules.

Calcium Hardness: The content of calcium dissolved in water in the spa. Calcium hardness should be 150-200ppm. If the calcium content is too high, this will cause turbidity and scaling of the water. If its content is too low, this will cause damage to the spa equipment.

Chloramine: The compound produced by the combination of chlorine with nitrogen from skin oil, urine and sweat. Chloramine can irritate the eyes and has a strong odor. Different from bromamine, chloramine is a weaker effect and slow functional disinfectant.

Chlorine: A high efficient spa- disinfectant. Recommends using Sodium bichloride in particulate form, because it can be completely dissolved and closes to neutral pH value, and therefore it is best to use sodium bichloride particles.

Residual Chlorine (or Residual Bromine): Refers to the residual amount of chlorine or bromine, after the demand of chlorine or bromine has been satisfied. Thus, the residual amount is the amount of chemical disinfectants that can be used to kill bacteria, germs and algae.

Corrosion: Refers usually to gradually damaging to metal parts of the spa due to chemical reaction. Under normal circumstances, the correction can happen, if pH value is low, or the level of TA, CH, pH value and disinfectants exceeds the recommended range.

DPD: Refers to the optimal reagent using for free residual chlorine measurement.

Halogen: One of the five elements fluorine, chlorine, bromine, iodine and astatine.

MPS: Monopersulfate, which is a chlorine-free oxidant.

Pathogens: Refers to microorganisms such as pathogenic bacteria.

pH Value: Refers to the measuring value of water acidity. Recommended pH value is 7.2-7.6. When the pH value is less than 7.0 (neutral value), the water acidity is greater and this will damage the heating system. When the pH value is higher than 7.8, the water alkaline is too large, and this result in water turbidity and scaling on the tub surface housing and heater.

PPM: Abbreviation of millionth, the measurement standard unit of the chemical content in the water, equal to "mg/l" (mg/liter).

Reagent: Refers to chemicals for chemical testing in liquid, powder or flake form.

Disinfectant: Refers to disinfectants that has been added and maintain the recommended residual amount. They are used to protect bathers against the damage from pathogenic organisms, which can cause disease and infection of the spa water.

Scale: Refers to coarse sediments containing calcium that cover the spa tub surface, heater and water pipes or block filter. In general, if the water contains minerals and has a high pH value, the scale will be formed. In addition, scale can be formed more easily at higher water temperature.

Oxidation Treatment: When using chlorine, it is also known as "super-chlorination treatment." Oxidation treatment refers to add a large dose of instant disinfectant (recommend using " sodium bichloride") to remove chloramines and bromide by the oxidation of organic waste that can be not filtered out.

Total Alkalinity: Refers to the amount of heavy carbonate, carbonates and hydroxides in the spa water. A proper total alkalinity is every important for pH value control. If the total alkalinity is too high, it is difficult to adjust the pH value. If the total alkalinity is too low, the pH value is difficult to maintain at an appropriate level. The ideal range of total alkalinity in the spa water is 125-150ppm.

TROUBLE SHOOTING

Spa Water Quality Solution

Guide For Problem Solving In Spa Water		
Error	Possible reason	Solutions
Water Turbidity	<ul style="list-style-type: none"> • Filter dirty • Greasy organic matter too much, • Improper disinfection, • Particulate/organic matter too much • Too often with too much water or too long 	<ul style="list-style-type: none"> • Clean the filter, • Carry out oxidation treatment to spa with disinfectants • Add disinfectant • Adjust the pH value and/or alkalinity to the recommended range, • Start jet pump • Drain out the water and re-add water
Stinking Water	<ul style="list-style-type: none"> • Organic matter in water too much • Improper disinfection PH value is low 	<ul style="list-style-type: none"> • Carry out a oxidation treatment to the spa with disinfectant • Add disinfectant • Adjust the pH value to the recommended range
Chlorine Odor	<ul style="list-style-type: none"> • Chloramine content is too high pH value is low 	<ul style="list-style-type: none"> • Carry out a oxidation treatment to the spa with disinfectant, • Adjust the pH value to the recommended range
Musty Odor	<ul style="list-style-type: none"> • Bacteria or algae growth 	<ul style="list-style-type: none"> • Carry out a oxidation treatment to the spa with disinfectant. If the problem persists, please drain out water, Clean the spa and add new water
Accumulation Of Organic Matter Around The Spa/Scum	<ul style="list-style-type: none"> • Grease and dirt accumulation 	<ul style="list-style-type: none"> • Clean scum with a clean cloth-if the problem is serious, drain out water, remove scum with cleaning agent for • Spa surface and ceramic tiles, and then add water again.
Algae Growth	<ul style="list-style-type: none"> • High pH value • Low concentration of the disinfectant 	<ul style="list-style-type: none"> • Carry out an oxidation treatment with disinfectant to oxidation treatment to the spa and adjust the pH value. • Carry out a oxidation treatment with disinfectant to oxidation treatment to the spa and maintain appropriate disinfectant concentration
Irritating To Eyes	<ul style="list-style-type: none"> • Irritating to eyes • Low concentration of the disinfectant 	<ul style="list-style-type: none"> • Adjust the pH value • Carry out a oxidation treatment with disinfectant to oxidation treatment to the Spa and maintain appropriate disinfectant concentration
Skin Allergies /Skin Rash	<ul style="list-style-type: none"> • Unhealthy water Free residual chlorine concentration is higher than 5ppm 	<ul style="list-style-type: none"> • Adjust the PH value. Carry out a oxidation treatment with disinfectant to oxidation treatment to the spa and maintain appropriate disinfectant concentration. • Before using spa, lower the free residual chlorine concentration to 5ppm or less.
Taints	<ul style="list-style-type: none"> • Total alkalinity and/or pH value is too low Content of iron and copper in tap water is higher 	<ul style="list-style-type: none"> • Adjust the total alkalinity and/or pH value • Use metal deposit inhibitors
Scaling	<ul style="list-style-type: none"> • Calcium content in the water is higher, total alkalinity and pH value is too high 	<ul style="list-style-type: none"> • Adjust the total alkalinity and/or pH values - if need to remove deposits, drain out water, clean fouling, adjust total alkalinity and pH value after re-adding water

If your Spa seems not to work properly, please refer to the "Starting Up" and "Operation" instructions in this manual. If this does not help you solve the problem, please follow the following instructions. If you still can't resolve the problem, please contact your Authorised Spa Dealer.

Spa Problem Solution

Guide For Troubleshooting In General Operations		
Error	Possible reasons	Solutions
Entire spa does not work	<ul style="list-style-type: none"> Power failure GFCI tripped Heater overheat protection temperature switch tripped Spa lock is opened 	<ul style="list-style-type: none"> Check the power Reset the GFCI. If it can be not reset, please call the service personnel Disconnect the power for at least 30 seconds, reset heater overheat protection switch. If it can be not reset, please ckeck whether the filter is clogged. If the switch still trips, please call the service personnel Stop using the spa lock
Weakness or intermittent injection	<ul style="list-style-type: none"> Water level is too low The filter is clogged Air valve is closed 	<ul style="list-style-type: none"> Add water Clean the filter Open the air valve
All the lights don't shine	<ul style="list-style-type: none"> Spa lock is opened Connection or interface failure between the light and the control box 	<ul style="list-style-type: none"> Stop using spa lock Call service personnel
All the lights don't shine	<ul style="list-style-type: none"> Lamp wiring fault The main light device failure Lamp wiring is not connected to the fiber bundle 	<ul style="list-style-type: none"> Remove the panel, reconnect the LED lights with fiber bundles. If the light still does not shine, call service personnel
Indicator light "Power and ready" is blinking	<ul style="list-style-type: none"> Filter dirty The water level is too low The pressure switch has problem. 	<ul style="list-style-type: none"> Clean the filter See the "Starting Up in this manual Disconnect the power for at least 30 seconds. If the indicator continues to flash after powering, call service personnel
Power indicator light is flashing, four lines display on the screen	<ul style="list-style-type: none"> Heater overheat protection temperature switch tripped 	<ul style="list-style-type: none"> Disconnect the power for at least 30 seconds, reset protection switch. If the switch can be not reset, check whether the filter is clogged. If it still trips,call the service personnel
Indicator light "Ready" flashes	<ul style="list-style-type: none"> Temperature sensor fault 	<ul style="list-style-type: none"> Disconnect the power for at least 30 seconds. If the lights continue to flash after power on, call the service personnel
Spa can be not properly heated	<ul style="list-style-type: none"> The temperature setting is too low Spa cover is not in place The filter is dirty Summer timer is turned on 	<ul style="list-style-type: none"> Set a higher temperature on the control panel Align Spa cover Clean the filter Switch the summer timer to the off position.
Jet pump motor does not work	<ul style="list-style-type: none"> Motor overloading If the jet symbol does not shine, it is a control switch malfunction 	<ul style="list-style-type: none"> Cooling one hour. Motor overloading will automatically reset. If the problem persists, please contact your Authorised Spa Dealer.
Jet pump or motor noise is too high	<ul style="list-style-type: none"> Water level is too lower 	<ul style="list-style-type: none"> Disconnect the power supply and contact your dealer. Add water to the normal level (2.5 cm or 1 inch above the highest jet)
Jet pump motor runs, but pressure/injection	<ul style="list-style-type: none"> Air control valve closed or clogged 	<ul style="list-style-type: none"> Open or clean air valves
Pressure is very low	<ul style="list-style-type: none"> Water level is too low The filter is dirty Jet clogged Filter net or filter basket clogged 	<ul style="list-style-type: none"> Add water to the normal level (2.5 cm or 1 inch above the highest jet) Clean the filter Remove the eyeball on the jet panel and clean the jet hole Clean filter net cover or filter basket
Diverter valve rotates difficult	<ul style="list-style-type: none"> Sand deposits in valves 	<ul style="list-style-type: none"> Clean and lubricate the diverter valve in accordance with the diverter valve maintenance instructions
After filling or adding water, a jet pump works properly, but all jet spray no water.	<ul style="list-style-type: none"> Jet pump does not start properly. 	<ul style="list-style-type: none"> Shut off the power on circuit breaker and remove the spa cabinet (see "Drain Your Spa" section) Loosen the joint on jet pump top (see "Winter Preparation"), so that air can enter, then tighten the joint with hand. Restore power for spa, start the jet pump, check and make sure that the joint closely to prevent leakage. Replace the spa cabinet, or remove and re-install the filter cap.

Start Water Pump: By adding or replacing the water, if the pump is operating but no water flows out from any jet, this indicates that the pump may not start properly. To solve this problem, please refer to the above mentioned steps and operate according the following procedures:

- Turn off the power of the Spa with the circuit breaker and remove the spa cabinet.
- Loosen the joint on the pump top to discharge air, and tighten the joint again when water flows.
- Turn on the power, start the water pump and confirm that the joint was really tightened to prevent water leakage.

Service

Other Service Information

Control device and overheat protection temperature switch is equipped with a number of electronic sensors connected with spa pipes. The connection cables between sensors and the temperature switch in the control box may not be damaged or knotted.

The jet pump is equipped with a thermal overload circuit breaker to prevent overheating of the water pump. If the pump shuts itself down after the spa is used for some time, it may be a failure of the pump motor bearing. If the water pump shuts itself off by a new type spa, it is usually caused by one or more of the following factors:

- Some of them are more sensitive and can close the water pump at a lower temperature.
- High temperature: All models of the spa are equipped with a jet pump and the motor of the jet pump will generate heat. Your spa has an air outlet leading to outside of the spa cabinet to prevent the jet pump motor from overheating. If the outlet is blocked by debris or grass clippings, it could lead to overheating of the jet pump. After the jet pump motor has been sufficiently cooled down and the blockage has been removed, the jet pump can be restarted.
- Friction: The moving parts of a new pump are sometimes too tight, this can lead to friction heat.
- After a normal break-in period, the pump temperature will be reduced.
- Improper Connection: When an extended cable is used or the cable diameter in your home is too small, the voltage could be too low for the water pump. This can lead to an excessive current and heat.

If the jet pump stops due to overheat, you must ensure a sufficient ventilation of the spa cabinet. Don't block the air vents at the bottom of the spa cabinet. If the jet pump also stops after use for some time, please contact a qualified service personnel.

Behaviors Leading To Invalid Warranty

- The limited warranty will be invalid, if there are the improper installation, alteration, misuse or abuse of the spa or reparation by personnel who are not authorized by company, behaviors such as alteration of any parts or pipes, any electrical change as well as the installation of unapproved sanitation equipment, water purification equipment or heating system, that lead to the promotion of component failure, main equipment failure or unsafe working conditions, are defined for the alteration.
- Misuse and abuse should include that the spa is not operated or used in a non-specified location according to instructions printed by company, detailed including: use of the spa in the non-residential applications; the damage because of the operation of the spa beyond the water temperature range 1.5°C(35°F) to 49°C (120°F) will let the limited warranty invalid.
- Damage caused by dirty filters, blocking or scaling, the surface damage of the spa caused the use of trichloroisocyanurate, bromochlorohydantoin (BCDMH), misuse of chemical tablets in floating devices, acid and any other company recommended spa surface chemicals or spa tub surface cleaning agents and cause damage will let the limited warranty invalid.

- Damage caused by the attachment of the insoluble spa disinfectants on the spa tub surface (no spa tub surface material can withstand this kind of abuse) and the damage of the components or the spa tub surface due to improper water chemistry maintenance will let the limited warranty invalid.
- The damage of the spa tub surface caused by direct sun exposure without water and tub cover (in warm climate regions, this might involve the solar heating) will let the limited warranty invalid. All such cases are treated as abuse.

▲ Warning: Operating a spa does not mean "using" the spa! Recommends not to use the spa, when the water level is above or below the temperature range of the control panel.

Disclaimer

- For the loss resulting from the use of the spa or other incidental, consequential, special, indirect, or punitive costs, expenses or damages, including but not limited to remove permanent platform, other customized fixtures or requirement on the crane for removing work. Company shall be not liable. Any implied warranty period is equal to the above applicable warranty period.
- Some states (or countries) don't allow to make a duration limit for the implied warranty. For any personal injury or property damage, for whatever cause, and regardless of the circumstances, Company and its representatives shall be not be responsible.

▲ Tips: Some countries or regions do not allow the exclusion or limitation of incidental or consequential damages, so the above limitations may not apply to you.

Customer Service

- If you have any questions in the installation, operation or maintenance of the spa that this manual does not answer, please consult with your Authorised Spa Dealer.

Declaration: Our company reserves the right to modify the product without notice.

